



USER MANUAL

CARGO CASE



TABLE OF CONTENTS

DIMENSION AND SPECS	4
HARDWARE COMPONENTS	6
CARGO CASE INSTALLATION	7
HARDWARE PREPARATION	8
PART LIST	9
INSTALL ACCESSORIES	10
CARGO CASE CARE AND SAFETY	12



IMPORTANT

The Cargo Case must be properly installed and securely attached to your vehicle. Failure to properly secure the mounts and cases to your vehicle could result in serious injury or even death.

Be sure to check the hardware after 10-20 miles after installation and after every trip off road to be sure it's still secured.

We are not perfect, but we strive to be the best. Your feedback and improvement ideas will help us to reach this goal. Follow the setup instructions to get started, and if you need any help along the way, email us at support@intrepidcampgear.com.

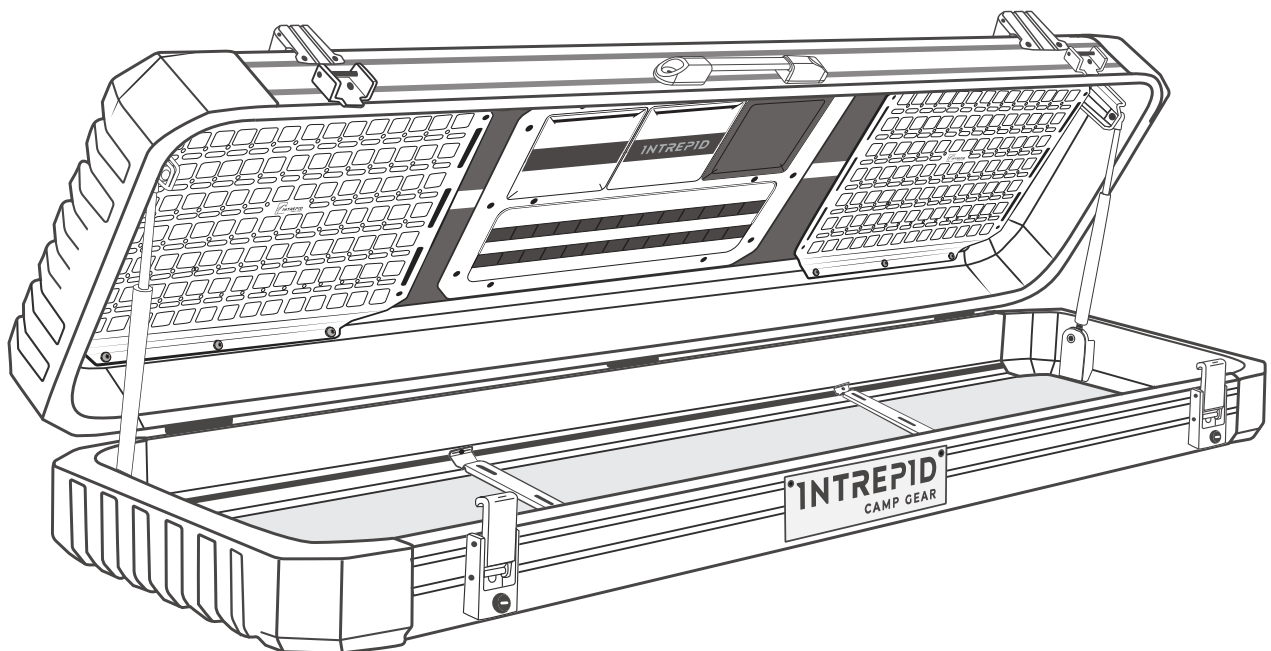

DIMENSIONS AND SPECS

ITX120 CARGO CASE 120L: _____

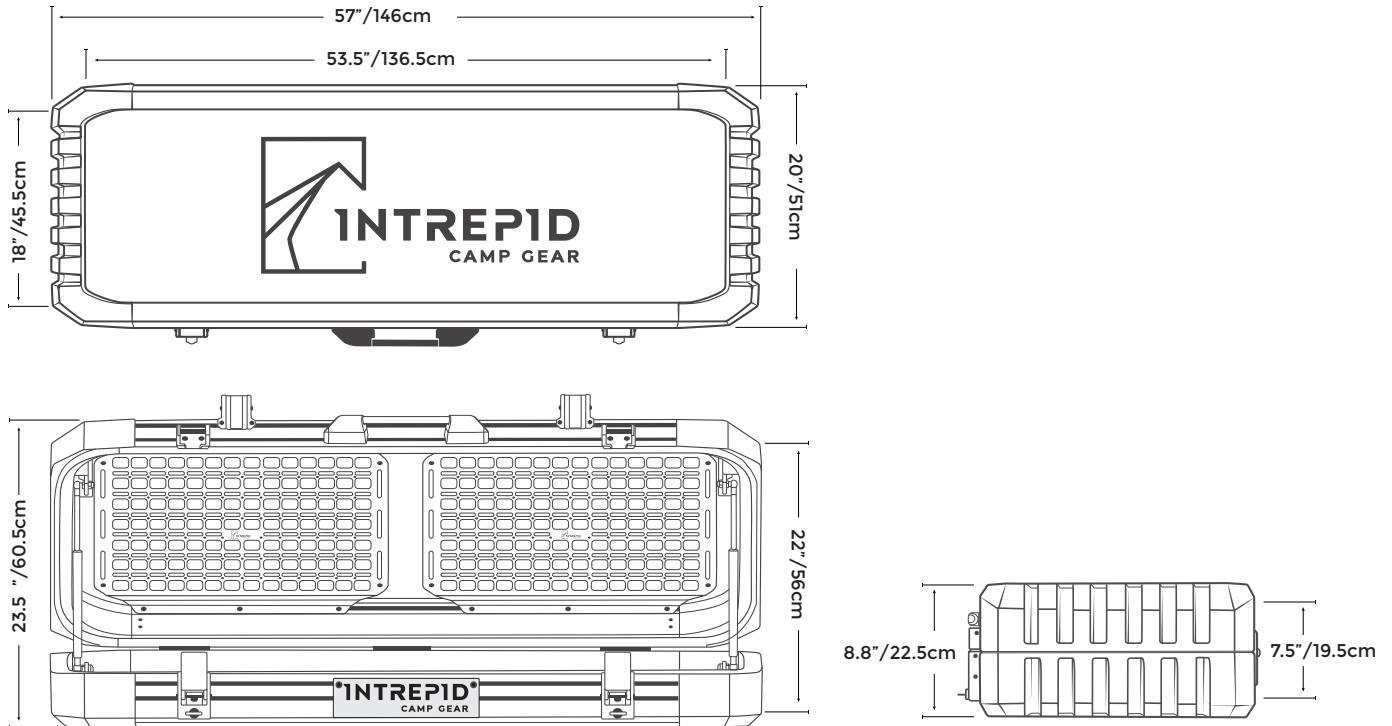

ITX190 CARGO CASE 190L: _____

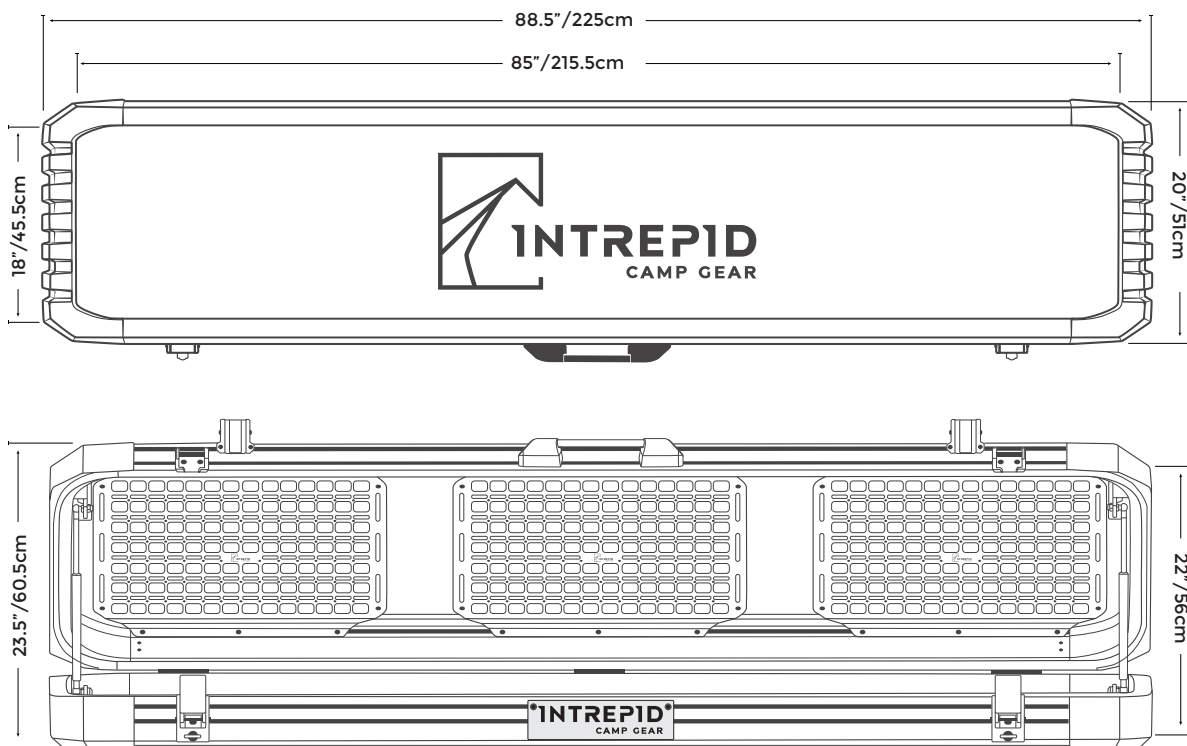

DIMENSIONS AND SPECS

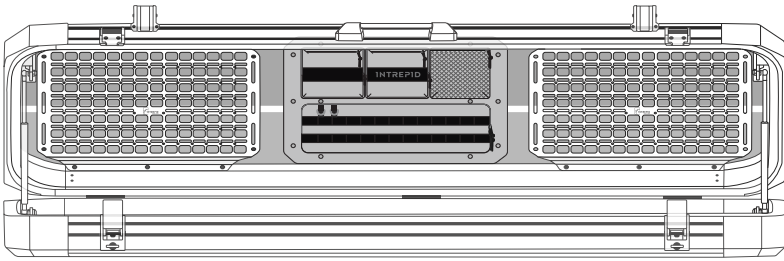

Note: Heavy-duty crossbars should be used when adding extra attachments on top.

ITX120 CARGO CASE 120L:

Weight	Cargo Case: 20kg/44 lbs
Interior Dimension	53.5" x 18" x 22" / 136.5cm x 45.5cm x 56cm
Exterior Dimension	57" x 20" x 23.5" / 146cm x 51cm x 60.5cm
Height Closed/Open	8.8" (22.5cm) / 23.5" (60.5cm)
Material	Aluminum + Composite

ITX190 CARGO CASE 190L:

Weight	Cargo Case: 29.2kg/64.3 lbs
Interior Dimension	85" x 18" x 22" / 215.5cm x 45.5cm x 56cm
Exterior Dimension	88.5" x 20" x 23.5" / 225cm x 51cm x 60.5cm
Height Closed/Open	8.8" (22.5cm) / 23.5" (60.5cm)
Material	Aluminum + Composite

HARDWARE COMPONENTS

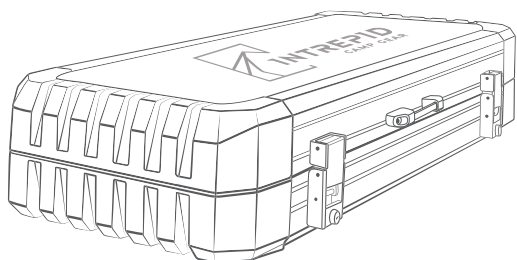

1. Cargo Case | x 1



2. Nonslip - Mat | x1 set

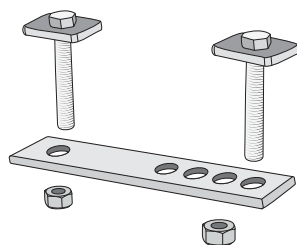

3. Vehicle connection brackets
Stainless steel lock plates | x 4 sets



4. Torx T30IP for bolt M13
Slim combination spanner | x1
x1

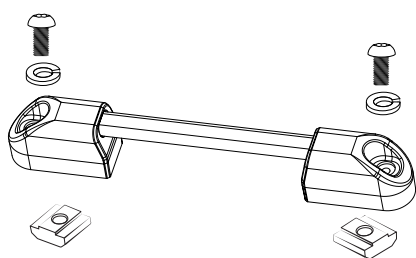

5. Handle + Bolts + Spring washer | x1 set

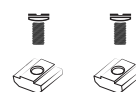

6. Logo Plate | x1 set

CARGO CASE INSTALLATION

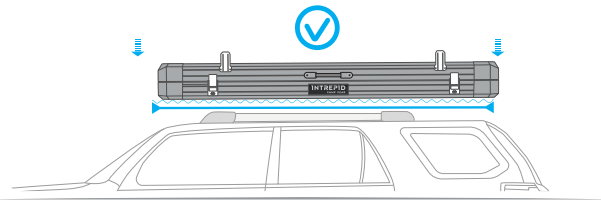

Parallel with the crossbar.

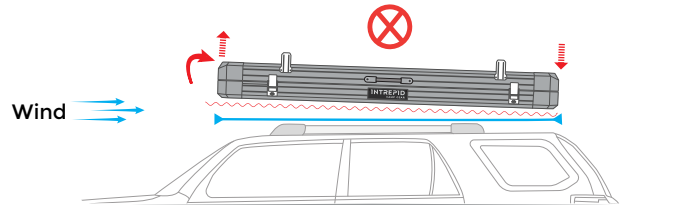

Back side down (drag force).

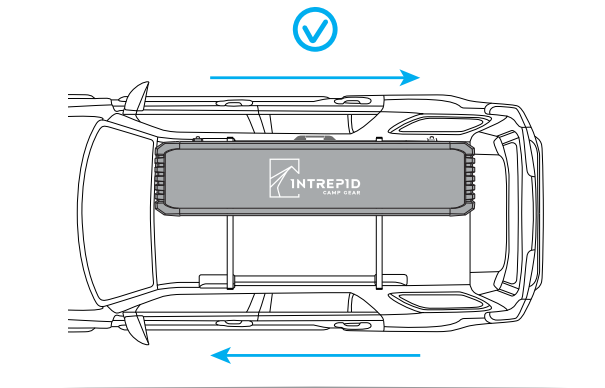

Parallel with the vehicle's body.

For optimal accessibility, we recommend mounting the Cargo Case at the edge of the vehicle's roof, parallel to it's body.

HARDWARE PREPARATION

1 INSTALL BOTTOM RAIL

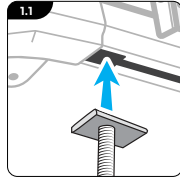
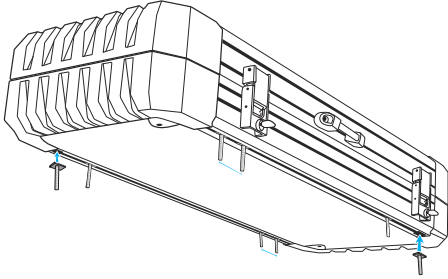

Insert x4 M8 bolts into the groove of the bottom side.

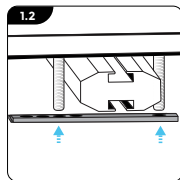
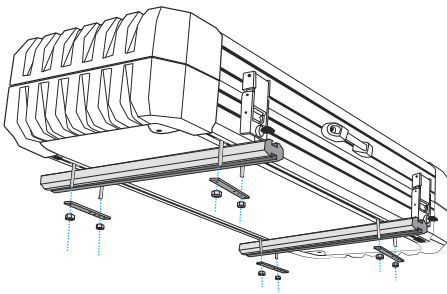

Adjust x2 M8 bolts on the 2 sides of the cross bar as the picture shows.

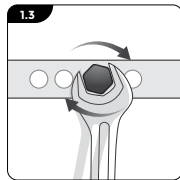
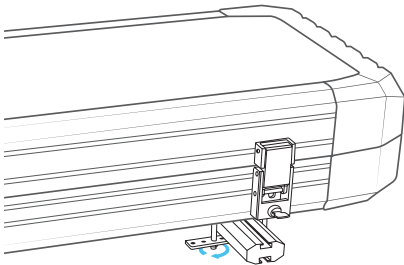

Attach Mounting Plate to M8 Bolts. Utilize the narrowest hole spacing allowed by your crossbar.

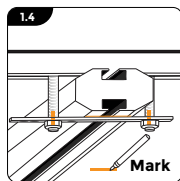

Tighten M8 Nuts until the mounting plate bends 5°-15°. Marking the bolt position as shown in the picture will help for future reattachment and to monitor the hardware.

ITX120 CARGO CASE 120L:

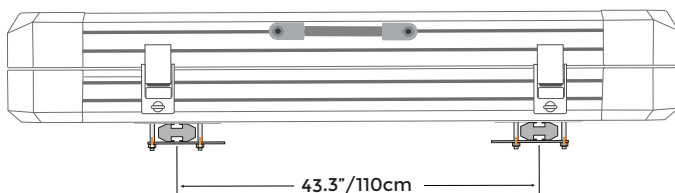

ITX190 CARGO CASE 190L:



Note: Hand tools are recommended to prevent nut and bolt from seizing.

PART LIST

ACCESSORIES (SOLD SEPERATLEY)

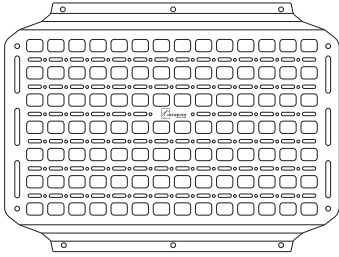

1. ITX Molle Panel

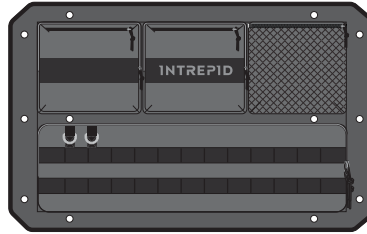

2. ITX Lid Organizer

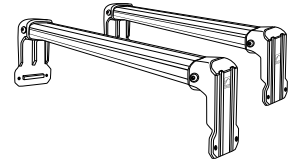

3. Cross Mount

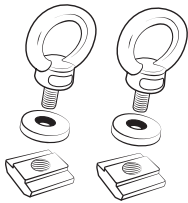

4. Eye Bolt & Kit

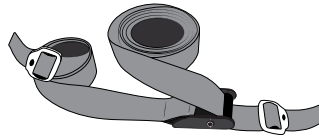

5. ITX Tie Down Strap

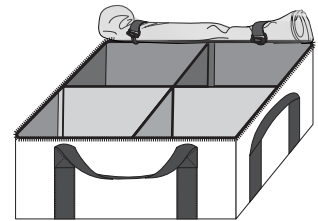

6. Soft Storage Bins

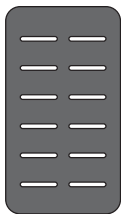

7. ITX Molle Patch - 12 Slots

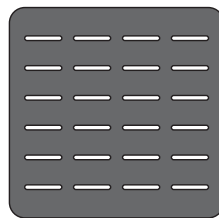

8. ITX Molle Patch - 24 Slots

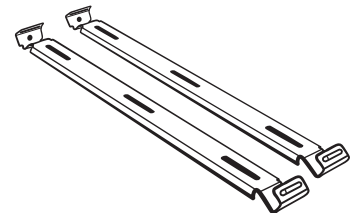

9. ITX Hard Binder



7. Mak Band Standard - 4 Slots



7. Mak Band Full - 3 Slots



10. Tactical Key Holder



11. Velcro Strap

2 INSTALL ITX MOLLE PANEL

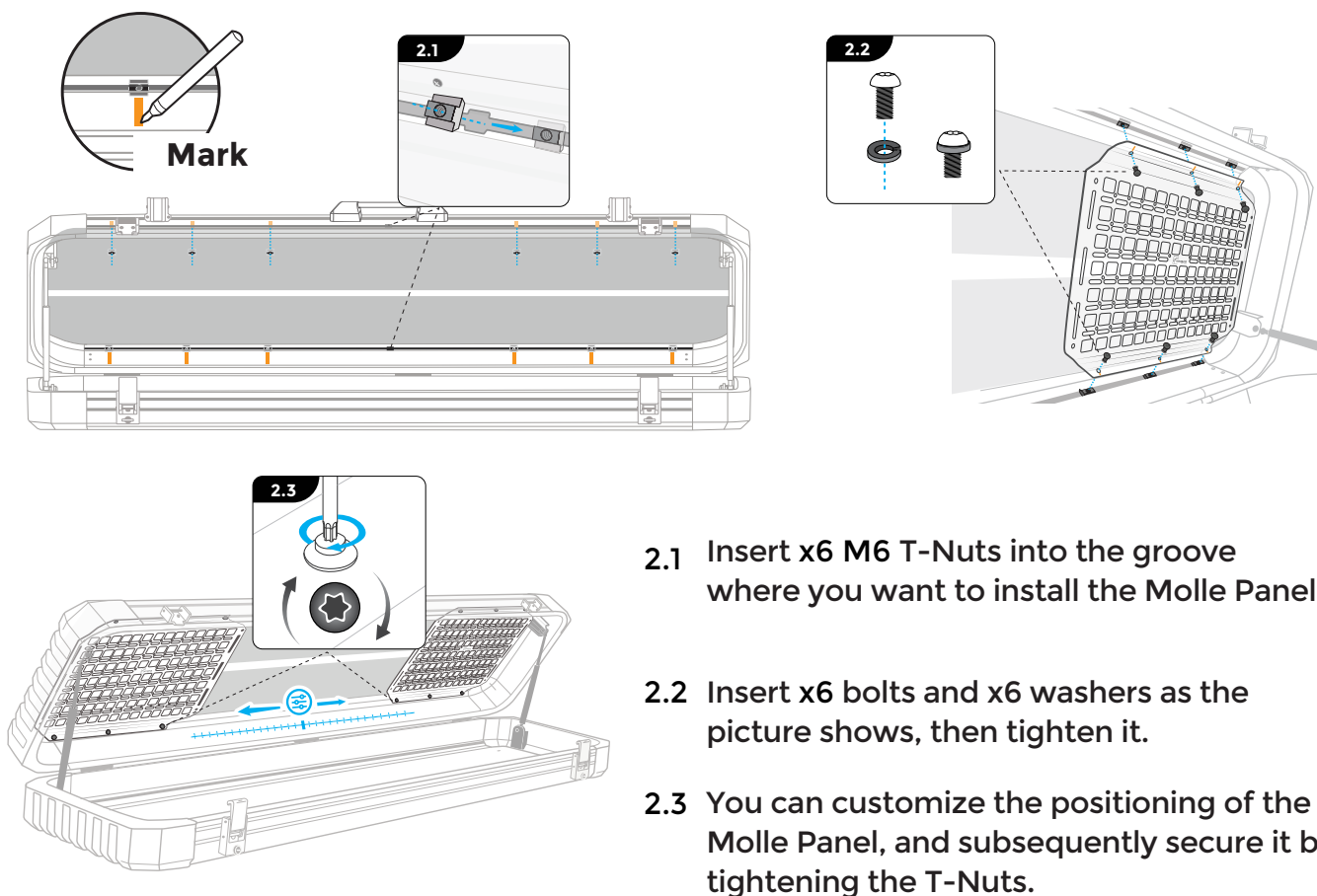

3 INSTALL ITX LID ORGANIZER



The organizer can be attached to the velcro system on the lid.

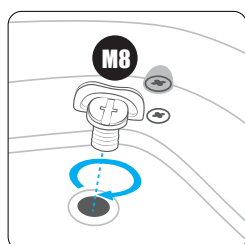

M8 Bolt Water Drain System: To clean the Cargo Case, simply fill it with water and then open the bolt to drain.

4 INSTALL ITX HARD BINDER

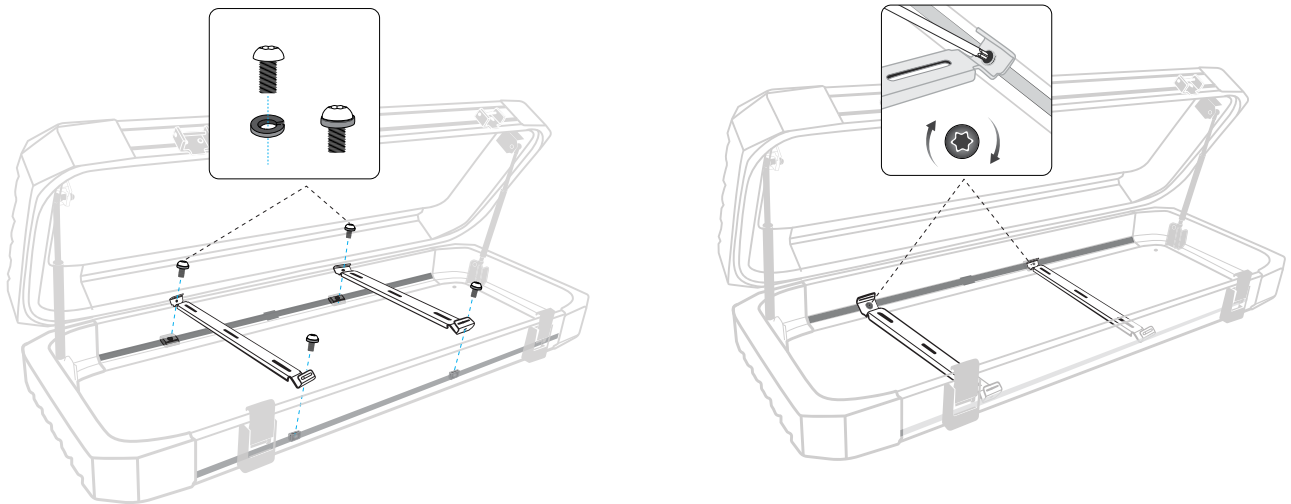

Insert x4 T-Nuts, x4 M8 bolts and x4 washers into the groove where you want to install the Hard Binder then tighten it.

5 INSTALL ITX TIE DOWN STRAP

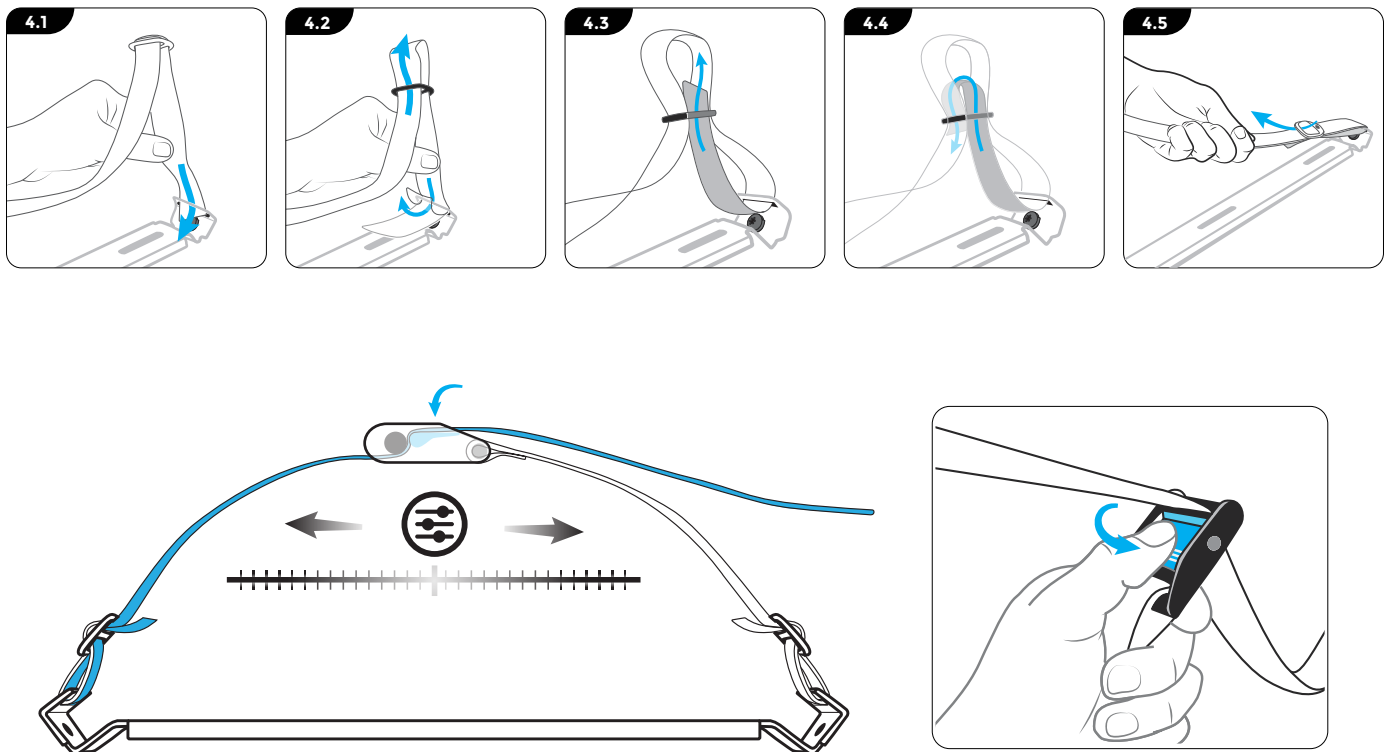

Wrap the strap securely around the item you want to secure. Ensure it's wrapped tightly and evenly.

CARGO CASE CARE AND SAFETY

CARGO CASE CARE:

- When not in use, store your aluminum Cargo Case in a cool, dry place out of direct sunlight.
- You can clean your aluminum cargo case with a mild soap and water. Avoid using harsh chemicals or abrasive cleaners, as these can damage the aluminum.



SAFETY:

- Always ensure that the latches and clasps are securely fastened before transporting or storing the case.
- Check hardware after 10-20 miles of initial driving and after every trip offroad to ensure every connection is secured.
- Gas struts are NOT to be used as handles. Doing so may cause gas struts to bend or gas leaking. Breaks of this kind are user error, not covered by our warranty policy.
- Keep gas struts rod away from dust as dust and rust may cause gas leakage.
- Before each camping season, or after prolonged use, be sure to check all the screws underneath the cargo case along the frame. Screws might be loosen over time due to vibration and gravity. Screws should be snug; but not overtightened. If you have any concerns please contact customer service at Intrepid Camp Gear.

For more information about our privacy practices, if you have questions, or if you would like to make a complaint, please contact us via our contact page or by mail using the details provided below:

support@intrepidcampgear.com
1711 Pearl Street, #101, Boulder CO 80302, United States

We are not perfect, but we strive to be the best. Your feedback and improvement ideas will help us to reach this goal. Follow the setup instructions to get started, and if you need any help along the way.



intrepidcampgear.com



<https://intrepidcampgear.com/>